

## SHELTER 6235

Designer: Birdseye Studios



### FRAME OPTIONS

- Mild steel

### FRAME FINISHES

- Galvanised
- Powdercoat

### ROOF OPTIONS

- Galvanised corrugated steel
- Colourbond® corrugated steel

### INSTALLATION

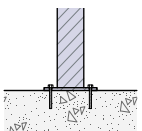

Bolt Down

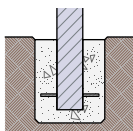

In Ground

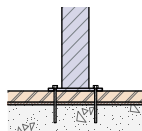

Bolt Through

### FIXINGS

- 12mm fixings for 14mm diameter holes

Alternative materials and finishes available on request

# KINGSTON SHELTER 6235

## SPECIFICATIONS

---

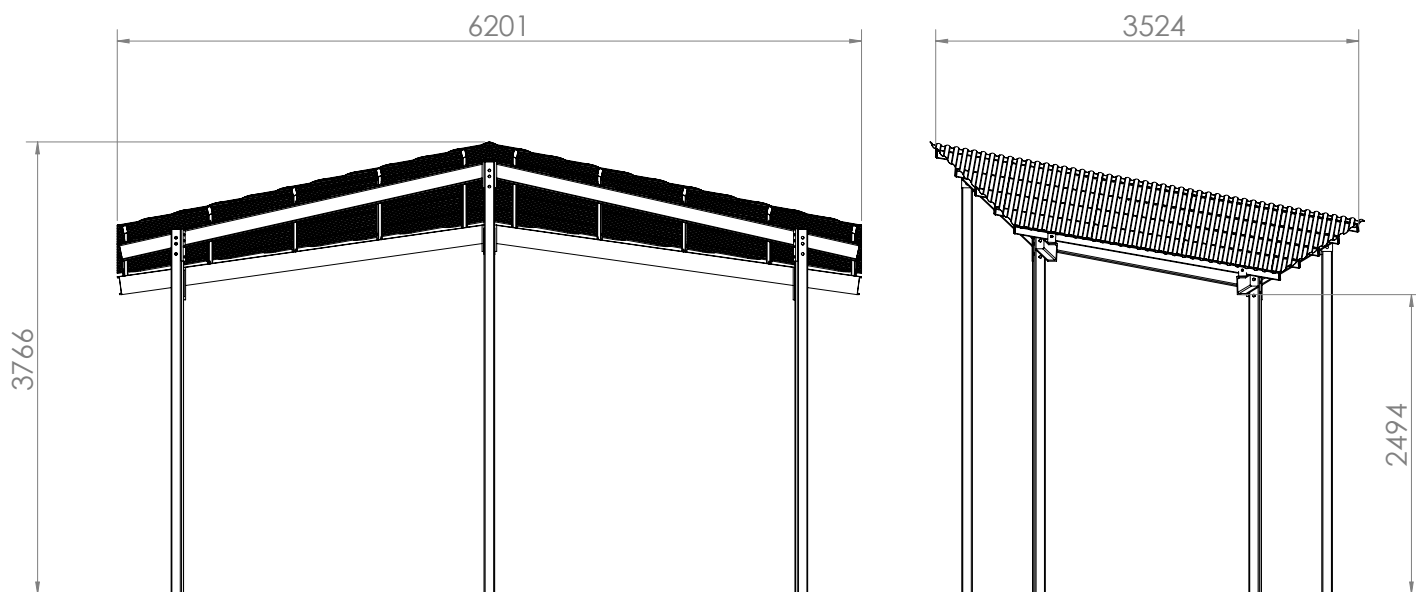

All measurements are in millimetres. Drawings are not to scale

---

PRODUCT CODES	FRAME FINISHES	ROOF OPTIONS
KST012-HDG-GV-6235	Galvanised	Galvanised corrugated steel
KST012-HDG-PC-6235	Powdercoat	Colourbond® corrugated steel